

KG10 Recessed Toilet Tissue Dispenser

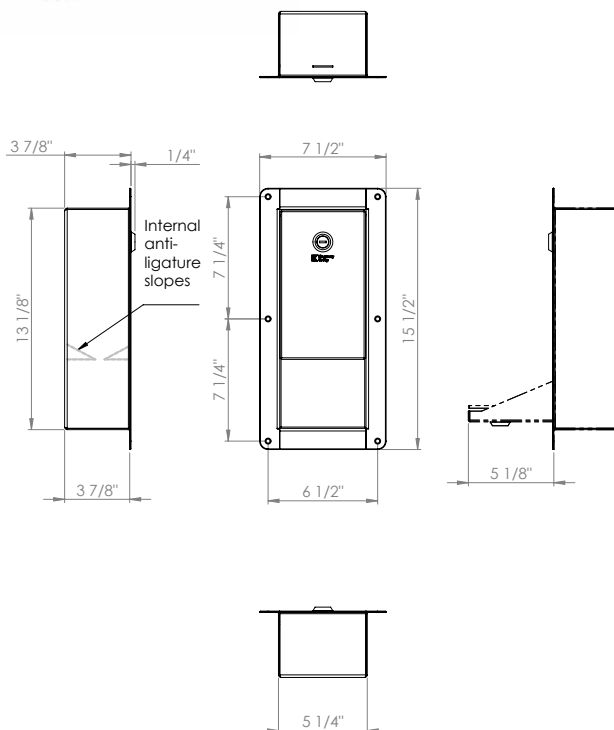

Product datasheet



Anti-ligature Disclaimer

Anti-ligature Disclaimer The anti-ligature design characteristics of this product are not intended to replace or substitute the need for necessary supervision of those who may be at risk, or for other necessary protective measures to be taken in the specific circumstances of usage. Kingsway Group, Inc. does not offer any products for sale as being 'ligature-free' and will not be liable for any claims arising from ligature attachment on its products. It is the customer's responsibility to ensure that products purchased and installed are suitable for the environments they are installed in.

The KG10 toilet tissue dispenser allows for the safe dispensing of toilet tissue sheets. It is made from high-grade stainless steel and is anti-ligature by design. Constructed of a secure outer casing with cam-lock operation to allow staff to open inner cassette for refill. The unit is supplied with a standard key and security screws for installation.

Installation description

- Mark out the location of the dispenser on the wall
- Drill holes for screws provided, allowing for anchors to suit wall construction type.
- Attach unit securely to the wall, additional tamper proof caulking can be applied around outer flange.

Operation and Maintenance

Operation

To fill the dispenser, unlock and pull the towards you. Fill the dispenser with toilet tissue sheets push back into closed position and secure with lock

Maintainance

Periodically check lock for smooth function and lubricate when necessary with a dry graphite lubricant.

Cleaning

Should be cleaned as part of regular schedule using standard detergents or disinfectants, avoid acidic cleaners.

Guarantee

5 Year Guarantee*

*For faulty manufacture and not for damage

Architectural Specification

Anti-ligature recessed toilet tissue dispenser with key lock and security screws. Inner cassette to open to allow refilling and have sloped internal slot to prevent ligature attachment or wedging.