

KG08 Manual Soap Dispenser GOJO Compatible

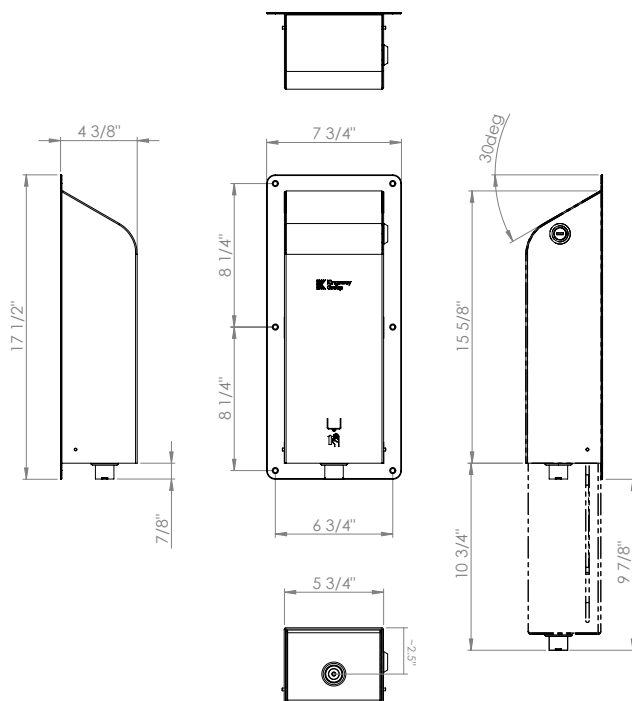

Product datasheet



Anti-ligature Disclaimer

Anti-ligature Disclaimer The anti-ligature design characteristics of this product are not intended to replace or substitute the need for necessary supervision of those who may be at risk, or for other necessary protective measures to be taken in the specific circumstances of usage. Kingsway Group, Inc. does not offer any products for sale as being 'ligature-free', and will not be liable for any claims arising from ligature attachment on its products. It is the customer's responsibility to ensure that products purchased and installed are suitable for the environments they are installed in.

The KG08 manual foam soap dispenser is designed to be compatible with the GOJO LTX-1200ml refill cartridges. The unit dispenses foam soap when the button is pressed on the bottom of the dispenser. It is made from high-grade stainless steel and is ligature-resistant by design. Constructed of a secure outer casing with cam-lock operation, to allow the inner cassette to lower for refill. The unit is supplied with a standard set of dispenser keys and security screws for installation.

Installation description

- Mark out the location of the dispenser on the wall, making sure to allow room for the inner cassette to slide down when unlocked for refill.
- Drill holes for screws provided, allowing for anchors to suit wall construction type.
- Attach unit securely to the wall, tamper-proof caulking is recommended to be applied around outer flange.

Operation and Maintenance

Operation

To replace the cartridge in the dispenser, start by unlocking and supporting the cassette, allowing it to slide down. When replacing the empty cartridge, ensure that the plastic nozzle/valve on the new soap cartridge aligns and seats properly into the top of the stainless steel nozzle. Push the cartridge down and into the dispenser, allowing the tabs on the new cartridge to slide into the slots on the Brackets within the Cassette. Slide the cassette into closed position and secure with lock.

Maintenance

Periodically check lock for smooth function and lubricate when necessary with a dry graphite lubricant.

Cleaning

Should be cleaned as part of regular schedule using standard detergents or disinfectants, avoiding acidic cleaners.

Guarantee

5 Year Guarantee*

*For faulty manufacture and not for damage

Architectural Specification

KG08 Ligature-Resistant surface mounted foam soap dispenser; GOJO LTX-1200 compatible with sloped top, key lock and security screws. Inner cassette to drop down to allow refilling.

This product is a refillable dispenser, and requires Soap/Sanitizer Cartridges to be purchased separately. Compatible with GOJO LTX-1200 ML cartridges.

KG08 Manual Soap Dispenser GOJO Compatible



Product datasheet

KG08 Product Refill List

The KG08 is compatible with GOJO's LTX-1200 Foam Refill Cartridges. This includes the GOJO, PURELL, and PROVON brands.

Sinks and Washrooms - Hand Soap

<i>Part Number</i>	<i>Description</i>
1911-04	GOJO Clear & Mild Foam Handwash https://www.gojo.com/en/Product/1911-04
1912-02	GOJO Antibacterial Plum Foam Handwash https://www.gojo.com/en/Product/1912-02
1916-02	GOJO Pomeberry Foam Handwash https://www.gojo.com/en/Product/1916-02
1922-02	PROVON Antimicrobial Foam Handwash With 2% CHG https://www.gojo.com/en/Product/1922-02
1940-02	GOJO Antimicrobial Foam Handwash With PCMX https://www.gojo.com/en/Product/1940-02
1941-02	PROVON Clear & Mild Foam Handwash https://www.gojo.com/en/Product/1941-02
1944-02	PROVON Foaming Antimicrobial Handwash With PCMX https://www.gojo.com/en/Product/1944-02

Corridors and General Areas - Hand Sanitizer

<i>Part Number</i>	<i>Description</i>
1902-02	PURELL SF607 Hand Sanitizer Foam https://www.gojo.com/en/Product/1902-02
1904-02	PURELL Advanced Hand Sanitizer Green Certified Foam https://www.gojo.com/en/Product/1904-02
1905-02	PURELL Advanced Hand Sanitizer Foam https://www.gojo.com/en/Product/1905-02

Anti-ligature Disclaimer

Anti-ligature Disclaimer The anti-ligature design characteristics of this product are not intended to replace or substitute the need for necessary supervision of those who may be at risk, or for other necessary protective measures to be taken in the specific circumstances of usage. Kingsway Group, Inc. does not offer any products for sale as being 'ligature-free', and will not be liable for any claims arising from ligature attachment on its products. It is the customer's responsibility to ensure that products purchased and installed are suitable for the environments they are installed in.