

PRODUCT DATASHEET

Pyrolux Vision Panels

Pyrolux clear glazed vision panels are designed for safe, high-strength performance in secure behavioral healthcare environments. Ligature-resistant by design, the panels combine two layers of Trident $\frac{3}{4}$ " impact-resistant glazing securely sealed between two 14GA Stainless Steel Fascias. These highly robust vision panels are available in 5 different sizes.



Terms and conditions:

To see our full terms and conditions, please visit:
kingswaygroupglobal.com/en-us/terms

Key Features:

- Ligature-resistant
- Double sided impact-resistant glazing
- 14GA stainless steel fascia
- No visible screws on the Secure (patient) side
- UL Certified
- Proven in challenging environments
- Safe observation solution

Glass Specification:

- Secure (Patient) Side: Trident $\frac{3}{4}$ " tempered glass
- Corridor (Staff) Side: Trident $\frac{3}{4}$ " tempered glass

Metal Fascia Specification:

- Secure (Patient) Side: Ligature-resistant pressed stainless steel fascia bolted from Corridor (Staff) Side, no visible screws / mounting hardware
- Corridor (Staff) Side: Ligature-resistant pressed stainless steel fascia through-bolted to Secure (Patient) Side with security screws

Certifications:

- UL rated to UL1784

Warranty

1 Year Manufacturer's Defect Warranty*

*For faulty manufacture and not for damage

PRODUCT DATASHEET

Pyrolux Vision Panels

Size Options:

The Pyrolux vision panel is available in the following sizes:

- P5020** Pyrolux vision panel 5" x 17" nominal size
- P5050** Pyrolux vision panel 17" x 17" nominal size
- P8020** Pyrolux vision panel 5" x 29" nominal size
- P8050** Pyrolux vision panel 17" x 29" nominal size
- P1330** Pyrolux vision panel 10" x 51" nominal size

All models manufactured for 1 3/4" thick doors



Terms and conditions:

To see our full terms and conditions, please visit:
kingswaygroupglobal.com/en-us/terms

Maintenance and Cleaning

Maintenance

Periodic checks should be made to ensure all screws are tight and that the panel is free from damage or tampering.

Cleaning

Pyrolux panels should be cleaned with extreme care using a damp cloth (not wet) and a mild detergent if required. Avoid caustic cleaners and do not allow the vision panel to come into contact with liquids.

Pyrolux Cross Section

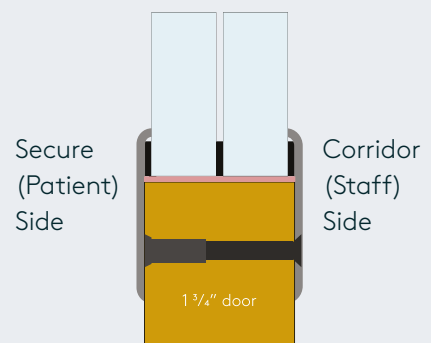

Trident 3/4" Glass on Both Sides

3/32" Intumescent spacers

3/32" Intumescent liner

Bolt fixed stainless steel fascia with no visible fixings on Secure (Patient) Side

PRODUCT DATASHEET

Pyrolux Vision Panels

Design Option Codes

Select your optional design features to help create a more therapeutic, non-institutional environment.

When specifying, add your chosen design code to the end of your product model number. For example, to add a 'Power Coated Fascia' to model P5020, your product code would be: 'P5020.PC01'.

<p>Wrapped Fascia</p>	<p>W01: Vinyl Wrapped Vision Panel fascia finish to Both Sides - from standard 3M Di-Noc range</p> <p>W02: Vinyl Wrapped Vision Panel fascia finish to Corridor (Staff) Side only - from standard 3M Di-Noc range</p> <p>W03: Vinyl Wrapped Vision Panel fascia finish to Room (Patient) Side only - from standard 3M Di-Noc range</p>
<p>Powder Coated Fascia</p>	<p>PC01: Powder Coated Vision Panel fascia finish to Both Sides - from standard RAL colour range</p> <p>PC02: Powder Coated Vision Panel fascia finish to Corridor (Staff) Side only - from standard RAL colour range</p> <p>PC03: Powder Coated Vision Panel fascia finish to Room (Patient) Side only - from standard RAL colour range</p>

Terms and conditions:

To see our full terms and conditions, please visit: kingswaygroupglobal.com/en-us/terms

PRODUCT DATASHEET

Pyrolux Vision Panels

Part Number	Door Thickness	DimA Fascia Height	DimB Fascia Width	DimC Glass Casement Height	DimD Glass Casement Width	DimE Visible Glass Height	DimF Visible Glass Width
P5020	1 3/4"	20 1/4"	8 1/2"	17"	5 1/8"	16 1/8"	4 1/4"
P5050	1 3/4"	20 1/4"	20 1/4"	17"	17"	16 1/8"	16 1/8"
P8020	1 3/4"	32 1/8"	8 1/2"	28 3/4"	5 1/8"	28"	4 1/4"
P8050	1 3/4"	32 1/8"	20 1/4"	28 3/4"	17"	28"	16 1/8"
P1330	1 3/4"	54 1/2"	13 1/4"	51 1/4"	9 3/4"	50 1/4"	9"

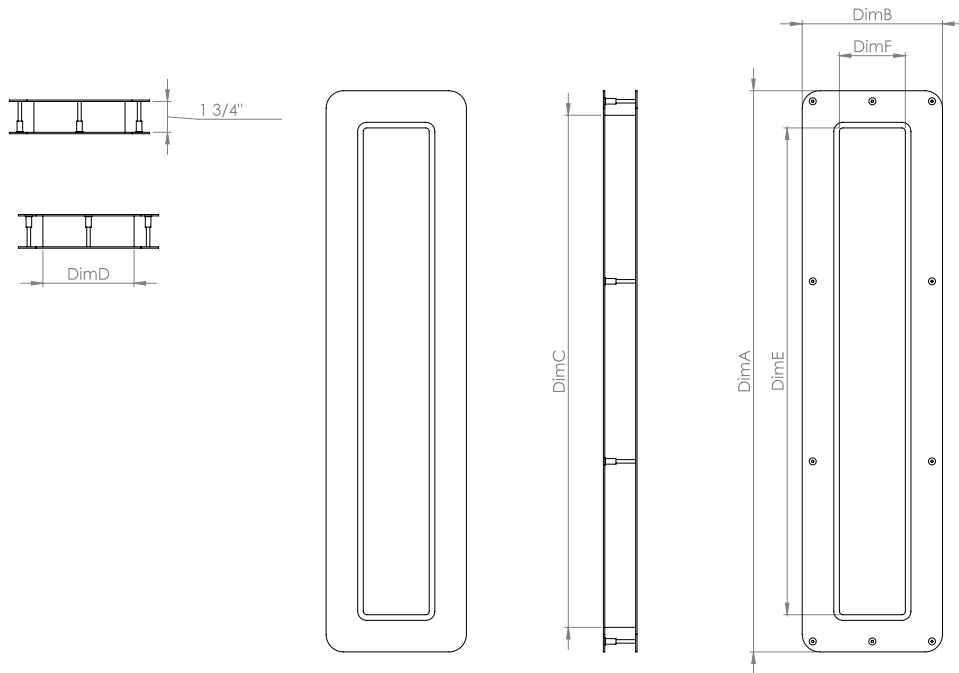

Terms and conditions:

To see our full terms and conditions, please visit: kingswaygroupglobal.com/en-us/terms