

Panorama Secure Glazed Screen System



Product datasheet



Panorama is a secure glazed screen system. To the patient side there is a stainless steel flush-mounted fascia, the hardwood liner is supplied to suit the wall depth and then finished with a bull-nose detail to the staff side.

The Panorama screen system can be supplied with a variety of glazing, the patient side is always supplied with the Trident 19mm attack resistant glass and then to the as optional extras on the staff side a Privilux integral blind unit to give controllable observation or the Lumex switchable glass which is turned from opaque to clear at the press of a button.

The Panorama screen system is 30 minute fire rated to a maximum size of 1200mm wide x 800mm high.

Product Codes:

PAN680 Panorama Secure Screen
800mm high x 600mm wide FD30 rated

PAN1280 Panorama Screen Screen
1200mm wide x 800mm high FD30 rated

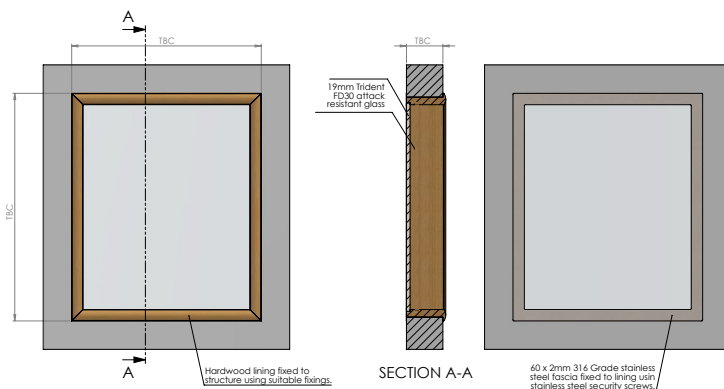

Anti-ligature Disclaimer

Anti-ligature Disclaimer The anti-ligature design characteristics of this product are not intended to replace or substitute the need for necessary supervision of those who may be at risk, or for other necessary protective measures to be taken in the specific circumstances of usage. Kingsway Group, Inc. does not offer any products for sale as being 'ligature-free' and will not be liable for any claims arising from ligature attachment on its products. It is the customer's responsibility to ensure that products purchased and installed are suitable for the environments they are installed in.