

Product datasheet

Kingsway  
Group

## KG13 Toilet Roll Holder

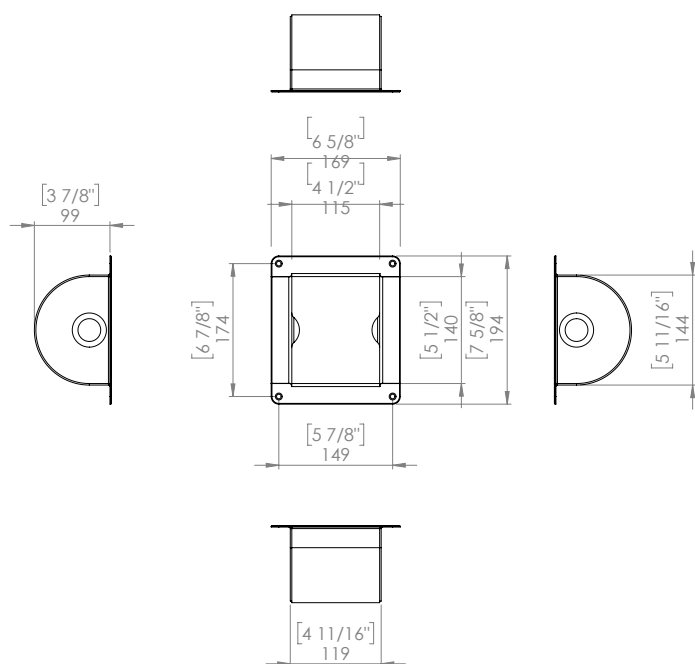

### Anti-ligature Disclaimer

Anti-ligature Disclaimer The anti-ligature design characteristics of this product are not intended to replace or substitute the need for necessary supervision of those who may be at risk, or for other necessary protective measures to be taken in the specific circumstances of usage. Kingsway Group, Inc. does not offer any products for sale as being 'ligature-free' and will not be liable for any claims arising from ligature attachment on its products. It is the customer's responsibility to ensure that products purchased and installed are suitable for the environments they are installed in.

The Kingsway recessed toilet roll holder provides a secure and effective means of dispensing standard toilet rolls whilst being anti-ligature by design. Manufactured from 316 grade stainless steel for maximum corrosion resistance and secured with anti-tamper fixings.

### Installation Description

- Create an opening in the wall to take the protruding part.
- Mark out for the fixing holes and drill and plug the holes.
- Fix in place using the security fixings supplied.
- We recommend that all washroom items are also sealed around all sides with anti-pick mastic.

### Operation and Maintenance

#### Operation

Place a toilet roll in to the opening and locate it so that it is locked in to both dimples allowing the toilet roll to rotate. Care should be taken that the correct size roll is purchased otherwise it will result in poor performance.

#### Maintenance

Periodic checks should be made to the fixings to ensure that they are secure and that there are no signs of damage or tampering.

#### Cleaning

Cleaning of the product should be with a damp cloth and mild detergent if required.

### Guarantee

#### Five Year Guarantee\*

\*For faulty manufacture and not for damage

#### Specification

KG13 Recessed Toilet Roll Holder