

## PRODUCT DATASHEET

# Pyrolux Vision Panels

Pyrolux clear glazed vision panels are designed for safe, high-strength performance in secure behavioral healthcare environments. Ligature-resistant by design, the panels combine two layers of Trident  $\frac{3}{4}$ " impact-resistant glazing securely sealed between two 14GA Stainless Steel Fascias. These highly robust vision panels are available in 5 different sizes.



### Terms and conditions:

To see our full terms and conditions, please visit:  
[kingswaygroupglobal.com/en-us/terms](https://kingswaygroupglobal.com/en-us/terms)

## Key Features:

- Ligature-resistant
- Double sided impact-resistant glazing
- 14GA stainless steel fascia
- No visible screws on the Secure (patient) side
- UL Certified
- Proven in challenging environments
- Safe observation solution

## Glass Specification:

- Secure (Patient) Side: Trident  $\frac{3}{4}$ " tempered glass
- Corridor (Staff) Side: Trident  $\frac{3}{4}$ " tempered glass

## Metal Fascia Specification:

- Secure (Patient) Side: Ligature-resistant pressed stainless steel fascia bolted from Corridor (Staff) Side, no visible screws / mounting hardware
- Corridor (Staff) Side: Ligature-resistant pressed stainless steel fascia through-bolted to Secure (Patient) Side with security screws

## Certifications:

- UL rated to UL1784

## Warranty

### 1 Year Manufacturer's Defect Warranty\*

\*For faulty manufacture and not for damage

PRODUCT DATASHEET

# Pyrolux Vision Panels

## Size Options:

The Pyrolux vision panel is available in the following sizes:

- P5020** Pyrolux vision panel 5" x 17" nominal size
- P5050** Pyrolux vision panel 17" x 17" nominal size
- P8020** Pyrolux vision panel 5" x 29" nominal size
- P8050** Pyrolux vision panel 17" x 29" nominal size
- P1330** Pyrolux vision panel 10" x 51" nominal size

All models manufactured for 1 3/4" thick doors



### Terms and conditions:

To see our full terms and conditions, please visit:  
[kingswaygroupglobal.com/en-us/terms](https://kingswaygroupglobal.com/en-us/terms)

## Maintenance and Cleaning

### Maintenance

Periodic checks should be made to ensure all screws are tight and that the panel is free from damage or tampering.

### Cleaning

Pyrolux panels should be cleaned with extreme care using a damp cloth (not wet) and a mild detergent if required. Avoid caustic cleaners and do not allow the vision panel to come into contact with liquids.

## Pyrolux Cross Section

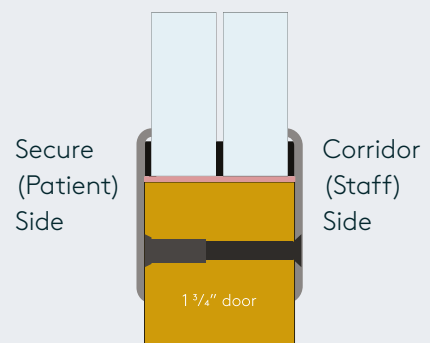

Trident 3/4" Glass on Both Sides

3/32" Intumescent spacers

3/32" Intumescent liner

Bolt fixed stainless steel fascia with no visible fixings on Secure (Patient) Side

## PRODUCT DATASHEET

## Pyrolux Vision Panels

## Design Option Codes

Select your optional design features to help create a more therapeutic, non-institutional environment.

When specifying, add your chosen design code to the end of your product model number. For example, to add a 'Power Coated Fascia' to model P5020, your product code would be: 'P5020.PC01'.

<b>Wrapped Fascia</b>	<p><b>W01:</b> Vinyl Wrapped Vision Panel fascia finish to Both Sides - from standard 3M Di-Noc range</p> <p><b>W02:</b> Vinyl Wrapped Vision Panel fascia finish to Corridor (Staff) Side only - from standard 3M Di-Noc range</p> <p><b>W03:</b> Vinyl Wrapped Vision Panel fascia finish to Room (Patient) Side only - from standard 3M Di-Noc range</p>
<b>Powder Coated Fascia</b>	<p><b>PC01:</b> Powder Coated Vision Panel fascia finish to Both Sides - from standard RAL colour range</p> <p><b>PC02:</b> Powder Coated Vision Panel fascia finish to Corridor (Staff) Side only - from standard RAL colour range</p> <p><b>PC03:</b> Powder Coated Vision Panel fascia finish to Room (Patient) Side only - from standard RAL colour range</p>

### Terms and conditions:

To see our full terms and conditions, please visit: [kingswaygroupglobal.com/en-us/terms](https://kingswaygroupglobal.com/en-us/terms)

## PRODUCT DATASHEET

# Pyrolux Vision Panels

Part Number	Door Thickness	DimA Fascia Height	DimB Fascia Width	DimC Glass Casement Height	DimD Glass Casement Width	DimE Visible Glass Height	DimF Visible Glass Width
P5020	1 3/4"	20 1/4"	8 1/2"	17"	5 1/8"	16 1/8"	4 1/4"
P5050	1 3/4"	20 1/4"	20 1/4"	17"	17"	16 1/8"	16 1/8"
P8020	1 3/4"	32 1/8"	8 1/2"	28 3/4"	5 1/8"	28"	4 1/4"
P8050	1 3/4"	32 1/8"	20 1/4"	28 3/4"	17"	28"	16 1/8"
P1330	1 3/4"	54 1/2"	13 1/4"	51 1/4"	9 3/4"	50 1/4"	9"

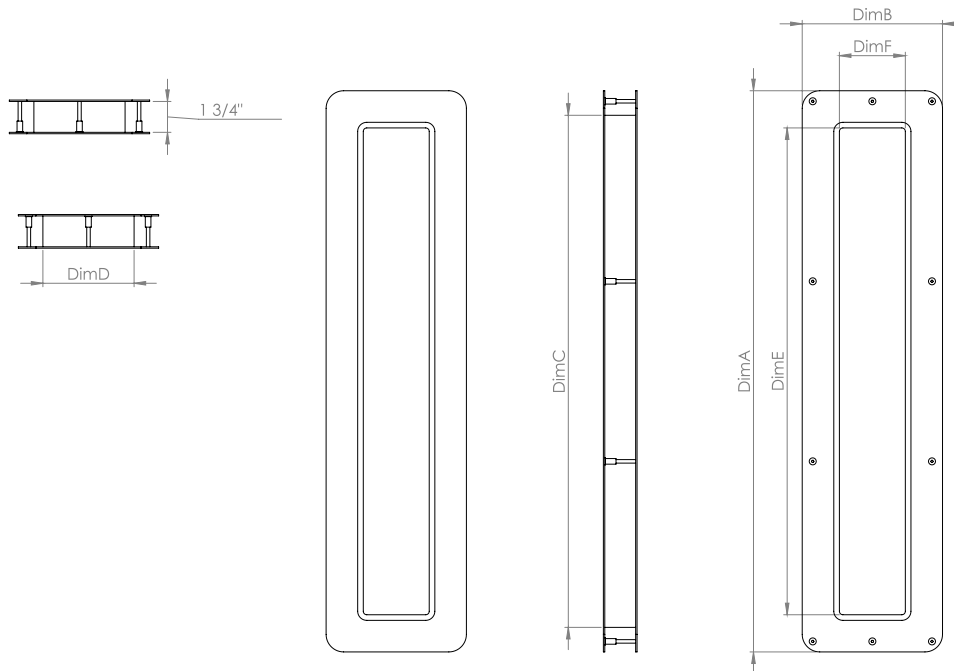
**Terms and conditions:**

To see our full terms and conditions, please visit: [kingswaygroupglobal.com/en-us/terms](https://kingswaygroupglobal.com/en-us/terms)