

Product datasheet

Kingsway  
Group

## KG279 L-Shape Grab Bar

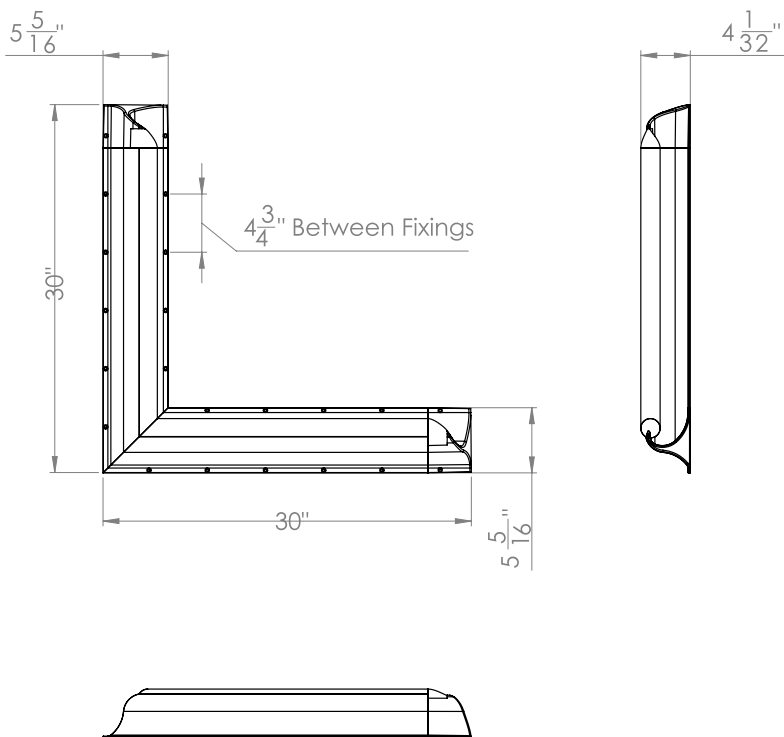
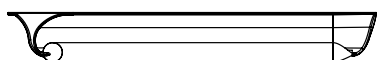

### Anti-ligature Disclaimer

Anti-ligature Disclaimer The anti-ligature design characteristics of this product are not intended to replace or substitute the need for necessary supervision of those who may be at risk, or for other necessary protective measures to be taken in the specific circumstances of usage. Kingsway Group, Inc. does not offer any products for sale as being 'ligature-free' and will not be liable for any claims arising from ligature attachment on its products. It is the customer's responsibility to ensure that products purchased and installed are suitable for the environments they are installed in.

The KG279 washroom grab rail is an L-Shape handrail section with two open end caps. It is suitable for use on a wall surface, installed in blocking for maximum strength. It is finished in a range of powder coating options and supplied with security screws. The overall Length of each side is 30", with the end caps taking up 3" of that.

### Installation Description

- Place the grab rail on the wall and mark out the screw holes.
- Drill holes for the screw holes and insert plugs
- Secure the grab rail in place using the security screws provided

### Operation and Maintenance

#### Operation

To grip the handrail correctly the fingers should curl round the grab rail with the thumb supporting from the outside.

#### Maintenance

Designed to be maintenance free, this is available in a Powder Coat finish as standard. Periodic checks for loose hardware are recommended.

#### Cleaning

Use only a damp cloth to clean the grab rail, where necessary a mild detergent can be used.

### Guarantee

#### 3 Year Guarantee\*

\*For faulty manufacture and not for damage

#### Specification

KG279 Anti-ligature L-Shape Grab Bar (one Wall)

This product is listed in the OMH patient safety guide. Include ".G" after model number if size being specified is required to be 'Graspable' Length (ex: KG270LH.G).



# Ligature Resistant Grab Bar

**Color Chart**

# Ligature Resistant Grab Bar

## Standard Color Range

The standard colors are from the RAL color range and are a powdercoated application with a gloss finish; custom colors are available.

RAL 1013 Oyster White

RAL 1015 Light ivory

RAL 1019 Gray Beige

RAL 5007 Brilliant Blue

RAL 7023 Concrete Gray

RAL 7032 Pebble Gray

RAL 7035 Light Gray

RAL 9002 Gray White

RAL 9003 Signal White

RAL 9006 White Aluminum



Ligature Resistant  
Product Specialists

Kingsway Group  
164 Indusco Court  
Troy, Michigan  
48083

[sales@kingswaygroupusa.com](mailto:sales@kingswaygroupusa.com)  
[www.kingswaygroupusa.com](http://www.kingswaygroupusa.com)