



Doorsets for mental health environments

Kingsway are the specialist manufacturer of pre-hung doorsets for the secure healthcare sector; supplying complete, fully-fitted doorsets for the most demanding healthcare environments. As a member of the third party Q-Mark fire door certification scheme, we provide the expertise to guarantee the successful outcome of your project and ensure compliance with regulations.

Installer Qualifications

Doorsets are technical products and should only be installed by competent personnel with suitable experience.

If full certification is needed, doors should be installed by BM Trada Q-Mark Scheme certified Fire Door Installers or by Kingsway Installers. It is the responsibility of the Client or Principal Contractor to ensure that only competent and correctly qualified persons are used for the installation process, as a poor installation will result in a lack of compliance and performance. Kingsway cannot sign off installation works by other contractors.



Storage, Protection & Handling



Pre Delivery Planning

Depending on the size of the delivery, the doors will be delivered by van or lorry and will arrive wrapped and multi-packed onto pallets. Please ensure a forklift or telehandler is available for pallet moving. Alternatively, if moving by hand, we suggest you provide 4 persons for the off load. By prior arrangement, a moffett enabled delivery may be possible at additional cost. Delivery scheduling and cost will be advised on estimate and we reserve the right to charge for failed or additional deliveries. We ask for 48hrs notice to postpone any scheduled deliveries.

Storage

It is essential that Kingsway doorsets are stored correctly to ensure that they appear and perform as specified. It is the responsibility of the contractor to ensure that all doorsets delivered are stored in a suitable area where they will be protected from harm by the elements and physical damage. The guidance below should be followed without exception:

- Doorsets should be stored near to the installation location, in a dry, well-ventilated area which has low moisture levels.
- Doorsets should always be stored horizontally to a maximum of 6 per stack. Cardboard bearers or equivalent should be used between each doorset to ensure hardware does not touch. Bearers should line up with each other down the stack to stop doorsets becoming bowed or twisted.
- Protective packing is there to ensure the doorset is installed without damage, do not unpack doorsets unless they are due to be installed. If a doorset has been unpacked prematurely it should be repacked and stored safely until ready for installation.

Protection

After installation, it is essential to protect the doorsets until handover of the building as other trades will be continuing around them. Suitable protection should be given to the doorsets against paint, dirt, minor impact and general use.

It is the overall responsibility of the contractor to assess how much protection is required and to provide it where necessary. Consideration should be given if doors are in direct sun light, as anything placed across the doorset may cause a silhouette marking to be left.

Handling

Kingsway doorsets are a high quality product that should be cared for accordingly. Our products are late second fix items and should only be installed after all wet trades have finished on site and the moisture level has returned to within the standard levels.

Extra care should be taken in the physical handling of Kingsway doorsets as these can often include heavy glazed panels or additional trims and fittings which contribute to the weight of the doorset. When lifting a doorset, make sure that there are enough personnel to assist and always work in accordance with the site's manual handling policy.



| Relative Humidity Rating (%) | Effects |
|------------------------------|--|
| Below 40% | Materials are susceptible to 'case hardening' where the cell structure is at risk of deformation (bowing/warping). Control measures are required. |
| 40-60% | Optimum level. Acceptable levels of moisture. |
| 60-75% | Materials begin to absorb moisture resulting in expansion and de-stabilisation. Control measures are required. |
| Above 75% | Materials absorbing high levels of moisture resulting in excessive swelling that may not be rectified. Activity must stop. |

Pre Install Planning for Approved Installers

Our doorsets arrive as single pre-hung units, complete with frames, architraves and all components factory fitted. We recommend they are installed after second fix carpentry phase to avoid the risk of damage. We also recommend they are installed after room furniture if possible. Flooring should be installed and finished ahead of door installation so that the door leaves do not need to be removed from their frames.

Check that you have the correct doorset for the opening and that it is free from any signs of damage. All doorsets are clearly labelled for correct identification, both on the outer packaging and also on the frame legs. Do not install a doorset into an opening that it has not been manufactured for and do not alter the size of a doorset to fit as this will invalidate the fire rating.

Before removing the packaging, check that the opening is big enough and that it is square. Any changes to the opening should be made at this point, prior to fully unpacking. Optimum gaps around the doorset are 7mm on each frame leg and 10mm on the head.

Check the floor levels. As many of Kingsway's doors are double action, the door will swing both inwards and outwards, meaning the level of the floor is critical. The floor level can cause the door to bind if the door catches on it, or it can make void the fire certification if the floor drops away at the threshold leaving a gap bigger than 8mm when the door is in closed position.

Check that you have suitable fixings for the wall that you are fixing into, and take care to note where wires are present when you plan your fixing points. Details on fixing requirements are shown on page 5.



How to identify which door I have?

Q-Mark Fire Door Plugging Details

The Q-Mark scheme uses plugs to identify the status and fire integrity of the doorset.

- Blue outer plug means the doorset has 60 minutes fire integrity (FD60).
- Yellow outer plug means the doorset has 30 minutes fire integrity (FD30).
- Red inner core means the door leaf is Q-Mark approved.
- Orange inner core means the glazing fitted to the door is Q-Mark approved.
- Silver inner core means that it is a complete, factory hung doorset.

Plugging of fire rated timber doorsets must be in the head of the door. This is located centrally across the width and 50mm from the opening edge of the door to allow the plugs to be seen when the doorset is installed. Where it is not possible to fit plugs in the head of the door, they should be fitted 50mm up from the bottom of the leading edge or on the door stop. Where glazing has been installed in the door leaf, the orange core plug should also be installed 30mm on from the doorset plug to indicate that the glazing installed is certified and has been factory fitted.



All Q-Mark certified doorsets must be installed without making changes to the configuration of hardware. No allowance is made for any extra fittings or vision panels to be added to them as they have been supplied as a certified complete doorset.



Example: An FD30 door having a vision panel will have 3 yellow plugs fitted: 1 with red inner core to show the door leaf is Q-Mark approved for 30 minutes fire integrity; 1 with orange inner core to show that the vision panel is Q-Mark approved for 30 minutes fire integrity; and 1 with silver core to show that the whole doorset has been factory hung and is Q-Mark approved for 30 minutes fire integrity.

Frame Fixing & Packing

When installing fire rated doorsets the correct choice of packers, fixings and sealants is critical to the performance of the door, both in terms of everyday use and in its fire performance. Care should be taken to follow the guidance below:

Install gaps

- Ensure suitable packers are used when positioning the door. These include timber shims and intumescent packers. For FD60 doorsets hardwood shims should be used. Care should be taken to ensure the packers are a tight fit yet do not bow the frame. The gap between the leaf and the frame should be kept within the tolerance of 2-4mm that it was supplied as and from the door to the threshold of 7-8mm to ensure fire and smoke integrity and validity of certification.

Fixings

- Fixings used should be suitable to the construction of the opening (see diagram) and should be positioned 100mm in from the top and bottom of each frame leg and also positioned between 400mm and 500mm apart. For the hanging jamb, pairs

Diagram 1

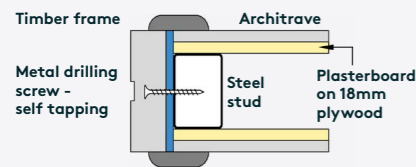

Diagram 2

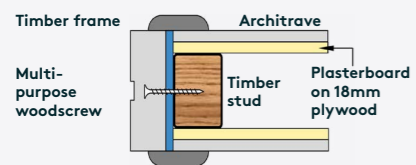
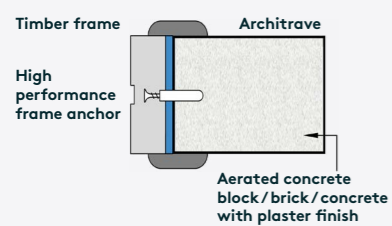

Diagram 3



Intumescent mastic

Kingsway recommend using intumescent packers and proprietary fire stopping (expanding PU foam) product for gaps of up to 20mm. Products must be tested for this application to BS 476: part 22: 1987 or BS EN 1634-1: 2000 or 2008.

of fixings should be used (see individual doorset drawings) and for the closing leg of the frame pairs of fixings should be used if the thickness is over 150mm. Where the frame is over 900mm wide, a fixing should be used in the frame head to ensure a correct gap is maintained with the door. Fixings should not be any nearer than 35mm from the wall face to avoid breaking out the wall surface.

- Test door action 90° both ways while fixing.
- The size of the fixing used can be determined by using the chart on the right. As a rough guide, fixings need to have a minimum of 60mm anchorage into the wall construction (85mm for heavy doorsets) taking into account any packing material used.
- For steel stud wall constructions as typical in contemporary new build scenarios, we recommend that door openings include timber (hardwood or softwood) inserts/ grounds behind the steel stud to reinforce door fixing and enhance the rigidity of the structural opening. Timber grounds must extend to the full height of the partition around door frames and should be of sufficient cross sectional dimension to provide 40mm to 60mm screw penetration. Upon request, we can provide a schedule of door weights to assist design of wall structures.
- Traditionally, once secured, the frame should be packed with rock fibre and capped on the front face with intumescent

Architraves

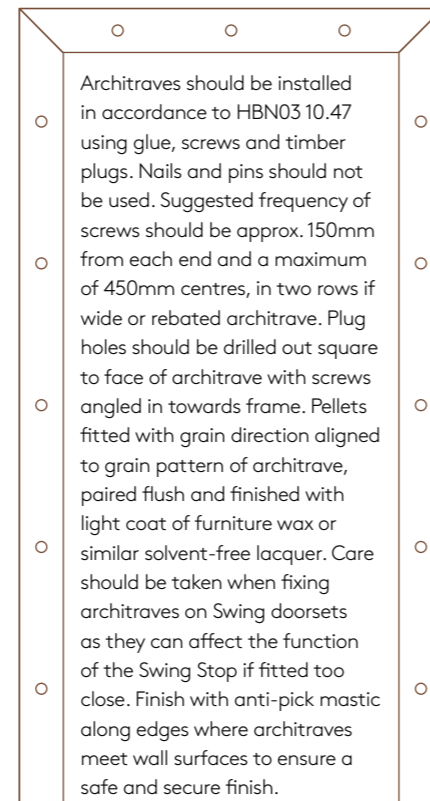

Architraves should be installed in accordance to HBN03 10.47 using glue, screws and timber plugs. Nails and pins should not be used. Suggested frequency of screws should be approx. 150mm from each end and a maximum of 450mm centres, in two rows if wide or rebated architrave. Plug holes should be drilled out square to face of architrave with screws angled in towards frame. Pellets fitted with grain direction aligned to grain pattern of architrave, paired flush and finished with light coat of furniture wax or similar solvent-free lacquer. Care should be taken when fixing architraves on Swing doorsets as they can affect the function of the Swing Stop if fitted too close. Finish with anti-pick mastic along edges where architraves meet wall surfaces to ensure a safe and secure finish.

mastic, however, contemporary installation methods would use expanding foam e.g. Blue 60 + Blue 60 packers in place of rock fibre, as long as the manufacturer has the data to cover the product for this type of application. BS EN 1634-1 & BS 476 part 22.

| Fixing Selector | | | | | |
|---|--|---|--|--|--|
| Wall material | | | | | |
| Frame Thickness | Steel Stud | Timber Stud | Aerated Concrete Block | Brick | Concrete |
| 32mm | Drill Tec 5.5 x 85 Metal Drilling Screw | 5 X 100mm Sonic Multi-purpose Woodscrew | SXRL 100mm High Performance Frame Anchor | SXRL 100mm High Performance Frame Anchor | SXRL 100mm High Performance Frame Anchor |
| 44mm | Drill Tec 5.5 x 100 Metal Drilling Screw | 5 X 120mm Sonic Multi-purpose Woodscrew | SXRL 120mm High Performance Frame Anchor | SXRL 120mm High Performance Frame Anchor | SXRL 120mm High Performance Frame Anchor |
| 60mm | Drill Tec 5.5 x 120 Metal Drilling Screw | 6 X 150mm Sonic Multi-purpose Woodscrew | SXRL 160mm High Performance Frame Anchor | SXRL 160mm High Performance Frame Anchor | SXRL 160mm High Performance Frame Anchor |
| Fixing Performance | | | | | |
| Fixing type | Individual Fixing Performance | Number Required Per Frame Leg | Overall Performance Of 1 Frame Leg | | |
| Drill Tec 5.5-gauge Metal Drilling Screw in Steel Stud | 12.5Kn | 4 | 50Kn | | |
| 5 X 100mm Sonic Multi-purpose Woodscrew In Timber Frame | 0.3Kn | 5 | 1.5Kn | | |
| SXRL 100mm High Performance Frame Anchor in Aerated Block | 0.32Kn | 5 | 1.6Kn | | |

Calculation of Force: A person weighing 100kg running at 7m/s will exert <1Kn

DOORSET INSTALLATION

STABLE

The STABLE Complete Door System provides the solution for medication dispensing and servery areas.



Installation Instructions

- Place the doorset in the opening and pack using suitable material to ensure the gaps are equal all round.
- Drill and fix the hanging jamb, taking extra care that it is free from bow and twist as this will affect the function of the split leaf design. It is advisable to pack between the leaves to ensure correct spacing.
- Drill and fix the closing leg, making sure the head is level.
- On doorsets wider than 900mm it is advisable to fix in the centre of the head to provide extra support and to maintain the correct gap.
- Fix frame, firestopping and architraves as detailed in guidance on 'fixings', page 5.
- Where Stable doors are supplied with Swing hinges, please use the relevant sections on the SWING instructions that refer to the installation of a Swing doorset.
- Fit all intumescent packers as provided. See page 7 for further details.



For further assistance with installation, please call +44 (0)20 3890 5887 or email us at: install@kingswaygroup.co.uk

Intumescent Details

Intumescent and seals guide:

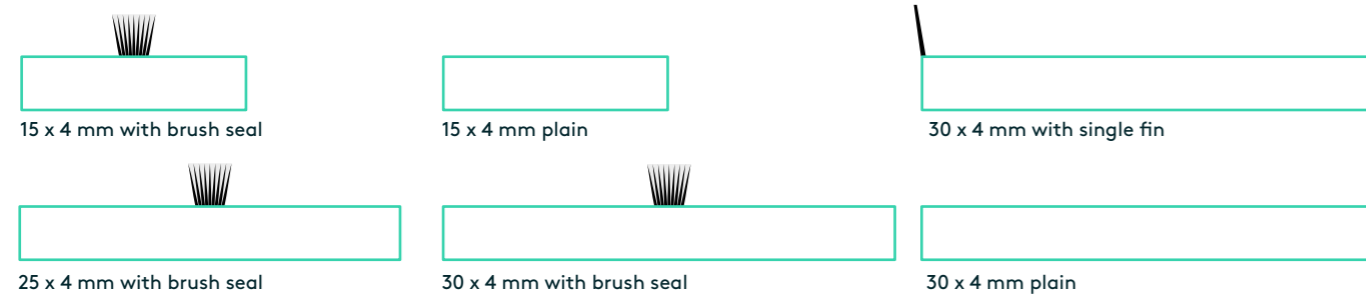

| Door type | Frame | Door | Head closer | DTM | SENTRY | KG21/KG35 & SENTRY |
|-----------|---|--|--|---|---|---|
| Solo | 15 x 4 mm brush in frame grooves (1 strip for FD30 and 2 for FD60) | N/A | N/A | 30 x 4 with edge fins to head, 15 x 4 with brush on the frame leg, only suitable for FD30 | N/A | 30 x 4 with edge fins to head, 15 x 4 with brush on the frame leg, only suitable for FD30 |
| Swing | Single Leaf | N/A | 15 x 4 plain in the frame head and 30 x 4mm brush in the door head | 30 x 4 with edge fins to head 15 x 4 with brush on the frame leg | Frame leg changes to 30 x 4 with edge fin | 30 x 4 with edge fins to head 15 x 4 with brush on the frame leg |
| | Leaf & Half | 1 no. 10 x 4mm brush plus 1 no. 10 x 4mm flat on vertical edge of half leaf | 15 x 4 plain in the frame head and 30 x 4mm brush in the door head | 30 x 4 with edge fins to head and 1 no. 10 x 4mm brush plus 1 no. 10 x 4mm flat on vertical edge of half leaf | N/A | 30 x 4 with edge fins |
| Switch | 15 x 4 mm brush in frame grooves 15 x 4 plain intumescent 80mm long directly above switch hinge | N/A | 15 x 4 plain in the frame head and 30 x 4mm brush in the door head | 30 x 4 with edge fins to head, 15 x 4 with brush on the frame leg | Frame leg changes to 30 x 4 with edge fin | 30 x 4 with edge fins to head 15 x 4 with brush on the frame leg |
| Stow | 15 x 4 mm brush in frame grooves | N/A | N/A | 30 x 4 with edge fins to head, 15 x 4 with brush on the frame leg | N/A | N/A |
| Stable | Flush Meeting Edge | Central meeting edge 30 x 4 brush in bottom of top leaf and 15 x 4 plain in top of bottom leaf | N/A | 30 x 4 with edge fins to head 15 x 4 with brush on the frame leg | N/A | N/A |
| | Rebated Meeting Edge | Central meeting edge 25 x 4 brush in bottom of top leaf and 15 x 4 plain in top of bottom leaf | 15 x 4 plain in the frame head and 30 x 4mm brush in the door head | 30 x 4 with edge fins to head 15 x 4 with brush on the frame leg | N/A | 30 x 4 with edge fins to head 15 x 4 with brush on the frame leg |
| Shower | N/A | N/A | N/A | N/A | N/A | N/A |
| Service | 15 x 4 mm brush in frame grooves (1 strip for FD30 and 2 for FD60) | N/A | N/A | N/A | N/A | N/A |



Installation Checklist

Inspection & Maintenance

| | | |
|---|----------------------|--|
| ▶ | Door Leaf | Ensure gaps from leaf to frame are within specified tolerance |
| | | Check the free movement of the door in both directions where applicable to ensure it doesn't catch on the floor |
| | | Free from damage |
| | | Fitting plumb, level and square in the frame |
| ▶ | Door Frame | Consistent gap between the door and frame as specified |
| | | Free from damage |
| | | Correct number, type, size and location of wall fixings |
| | | All fixings correctly plugged and finished |
| ▶ | Fire & Smoke Seals | Correct packing materials used between the wall and frame |
| | | Compatible with the doorset based on the instructions (See page 4) |
| | | Fitted flush in the grooves and without gaps |
| | | Smoke seals fill the gap between the door and frame on all sides |
| ▶ | Latch or Lock | Free from damage |
| | | Engages securely within the keep when closed |
| | | Operates without undue friction |
| ▶ | Hinges | Free from damage |
| | | Functioning correctly without undue friction |
| | | If the hinge has been taken off at some point check that it has been refitted correctly and all fixings are secure |
| ▶ | Anti-Barricade items | Swing Stops can open outwards fully without hinderance or friction |
| | | Switch hinges are operating correctly without friction |
| | | Door opens in both directions without binding on the floor |
| | | Free from damage |
| ▶ | Vision Panels | Functioning vision panels operate smoothly |
| | | Frames and glass free from damage |
| ▶ | Other hardware | Free from damage and correctly functioning |
| | | Door closers functioning correctly and fully closing the door |
| | | Electrical products correctly wired and functioning |
| ▶ | Architrave | Free from damage |
| | | Fitted correctly without gaps |
| | | All fixings either plugged or finished with wax |

All doors should be inspected regularly for damage that prevents the door performing in the event of a fire or an emergency situation, such as a barricade scenario. The following has been drawn up as a guide: **Maintenance must be carried out by a BM Trada certified door maintainer if installed by BM Trada door installer.**

| Area | Type of check | Frequency |
|----------------------|---|-----------|
| Door Leaf | Free from damage | 1 month |
| | Consistent gap between the door and frame as specified | 6 months |
| Door Frame | Free from damage | 6 months |
| Fire & Smoke Seals | All present and free from damage | 3 months |
| Latch or Lock | Engages securely within the keep when closed | 1 month |
| | Operates without undue friction | 1 month |
| | Free from damage and all fixings are present and secure | 1 month |
| Hinges | Functioning correctly without undue friction | weekly |
| | Free from damage and all fixings are present and secure | weekly |
| Anti-Barricade items | Swing Stops are functioning correctly without friction or damage and all fixings are present and secure | weekly |
| | Switch hinges are operating correctly without friction or damage and all fixings are present and secure | Weekly |
| | Door opens in both directions without binding on the floor | Weekly |
| Vision Panels | Functioning vision panels operate smoothly | Weekly |
| | Free from damage and all fixings are present and secure | Weekly |
| Other hardware | Free from damage, functioning correctly and all fixings are present and secure | Weekly |
| | Door locks and unlocks correctly without hinderance | Weekly |
| | Door closers are continuing to function correctly and close the door | Weekly |
| Architrave | Electrical products working correctly | Weekly |
| | Free from damage | 6 months |
| | Fitted correctly without gaps | 6 months |

Have a technical issue, or a query? Call +44 (0)20 3890 5887 or email us at: install@kingswaygroup.co.uk